



Weatherproof Analogue MCP (AAMCP-TWP)

Head Office

Wellington

PO Box 35-063
Naenae
Lower Hutt 5041
17 Eastern Hutt Rd
Wingate
Lower Hutt 5019
Tel (04) 567-3229
Fax (04) 567-3644

www.pertronic.co.nz

sales@pertronic.co.nz
tech@pertronic.co.nz

Auckland Office

PO Box 15-867
New Lynn
Auckland 0640
359 Onehunga Mall
Onehunga
Auckland 1061
Tel (09) 633-0226
Fax (09) 633-0228



ISO 9001: 2000

International
Standards
Certifications
QAC/R61/0051

Product Overview:

Pertronic Industries' Weatherproof Manual Call Point (AAMCP-TWP) has been designed to provide customers with an innovative, cost effective, easy to test, solution for MCP installations that require weatherproof (IP54 Plus rating). Pertronic Industries has combined proven design techniques with the latest technology to provide a highly reliable weatherproof analogue addressable MCP.



Standard Features:

- ▶ Weatherproof (IP54 Plus rated) when surface mounted.
- ▶ Built in Short Circuit Isolator with test bypass jumper.
- ▶ Safe, Secure, Commissioning without the need to remove the Snapglaze element.
- ▶ Push button latching switch with inbuilt bi-colour LED indicator.
- ▶ Low Profile Design.
- ▶ Electronic components protected from damage.
- ▶ MCP activated indication: Switch Illuminates Red.
- ▶ Isolator activated indication: Switch Illuminates Yellow.
- ▶ Weatherproof 'Snapglaze' frangible element for improved user safety. (Must be replaced when activated to retain IP54 rating).
- ▶ Fully complies with NZS 4512:2003 and NZS4512:2010.
- ▶ Terminals accept 0.5mm² to 1.5mm² cables.
- ▶ Connects to F100A or F120A analogue loops.

Specification:				
Electrical:	Operating Voltage 15 to 32Vdc	Quiescent Current 1.8mA	Alarm Current Alarm or Isolator active =11mA	
Environmental: IP54 Plus	Operating Temperature Range 0 to +40 °C		Humidity 10 to 95% RH (non-condensing)	
Mechanical:	Dimensions (H x W x D mm) 115 x 115 x 53	Weight 250 g	Material ABS Plastic	Colour Red
- Surface Mount				

Manual Call Point - Assembly:

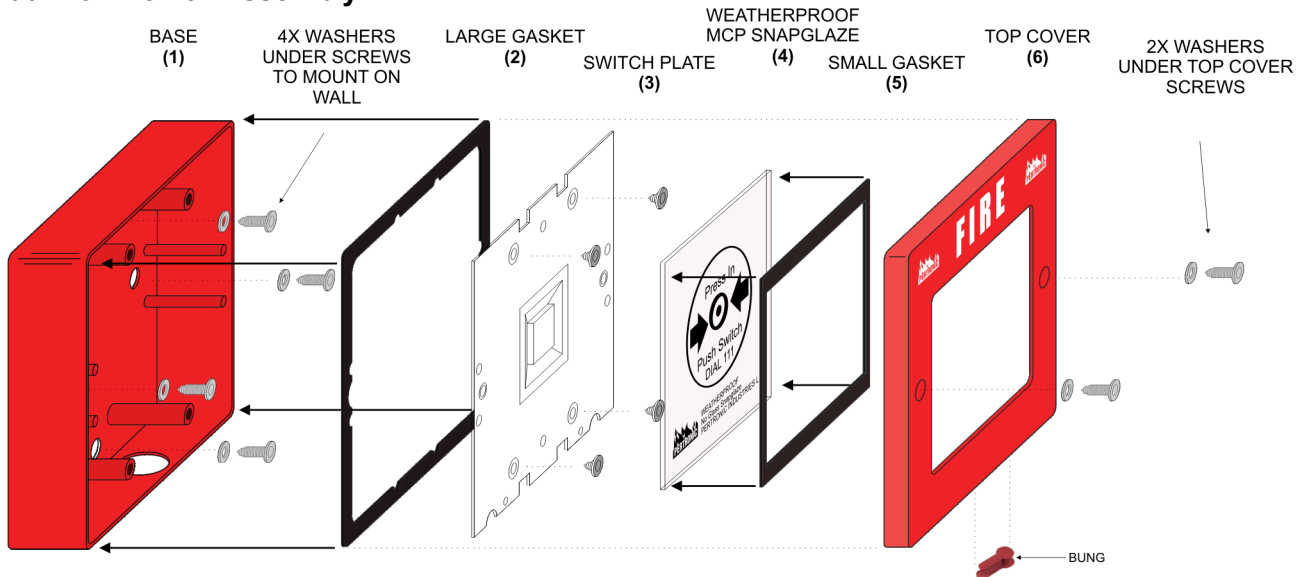

Manual Call Point - Wiring:

- ▶ Ensure rear-entry holes are drilled outside the indicated 'PCB Area' to avoid damaging the PCB.
- ▶ After terminating the cables, ensure that any excess cable is outside the indicated 'PCB Area' to prevent damaging the PCB when the Manual Call-Point is installed.
- ▶ Keep cable length inside the enclosure to a **maximum length of 150mm (6 inches)**. Alternately push excess cable into the cavity outside the enclosure.

Commissioning:

For ease of testing or commissioning, a custom made key is available that enables alarm functional testing of the MCP. Simply insert the Key in the hole located beneath the MCP (remove rubber bung if fitted).

To test the MCP (First ensure the Panel is in the 'Walk Test' mode). Push the key up into the hole located beneath the MCP, until the key paddle lines up with the push button switch. Turn the key anticlockwise to activate the MCP into Alarm. Once the MCP has been tested repeat the above step to return the switch and MCP to normal.

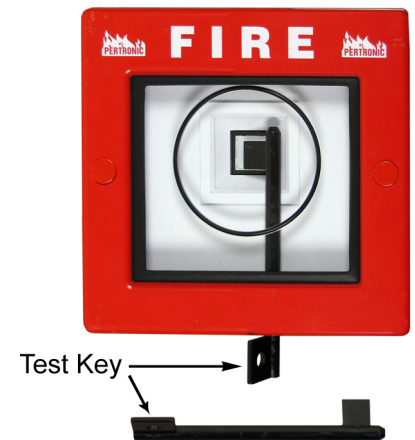

Product Codes:

Code	Description	NZFPA Listing No
AAMCP-TWP	AA Manual Call Point Testable Weather proof	PI/652
CPPSGWT-WP	Replacement 'Snapglaze' Window (Weather proof Product) (Press In Push Switch) text	
CPPTK	Activation Key (Approved Agents only)	
CPKHBUNG	Spare Keyhole Bung	

PERTRONIC INDUSTRIES LTD

Head Office:

17 Eastern Hutt Rd, Wingate, Lower Hutt 5019
Telephone (04) 567-3229 Fax (04) 567-3644

www.pertronic.co.nz
sales@pertronic.co.nz
tech@pertronic.co.nz

Auckland Office:

359 Onehunga Mall, Onehunga, Auckland 1061
Telephone (09) 633-0226 Fax (09) 633-0228

'Pertronic' and 'Firetronix' are registered trademarks of Pertronic Industries Ltd