



Audible Visible Accessories

System Sensor L-Series and L-Series with LED offer a wide range of Audible Visible (AV) accessories to enable you to meet a variety of application requirements.



Features

MP120KL(A) Mounting Plate

- Designed for both indoor and outdoor use
- Plug-in design eliminates ground faults
- Power supply that converts 120 VAC to nominal 24 V FWR
- Compatible with all two-wire L-Series devices (not used with L-Series with LED)

Color Lens Attachments

- Easily turns any device into a strobe for ECS/MNS events: severe weather, toxic gases, sprinkler activation and more
- Outdoor rated from -35°F to 151°F (-37°C to 66°C)
- Supports both wall- and ceiling-mount L-Series with LED notification appliances
- UL 1638 listed

Bezel Kits

- Easily turn a Fire or Plain device into a device to meet ECS/MNS requirements
- Choice of bezel kits printed with the words: FIRE, ALERT, EVAC, AGENT, FEU, FOGO, FUEGO, FUEGO/FIRE, or plain (no lettering)
- For use with L-Series and L-Series with LED devices
- Operating temperature -40°F to 151°F (-40°C to 66°C)
- Sold in packs of five

The **MP120KL(A) Mounting Plate** is designed to use 120 VAC to power standard L-Series horns, strobes, horn strobes, chimes, and chime strobes.

Color Lens Attachments install easily on any L-Series with LED strobe devices to provide distinctive visual signaling.

Bezel Kits enable installers to easily turn any L-Series or L-Series with LED Fire or Plain device into a device that meets ECN/MNS requirements, or into a bilingual FIRE device. Bezel kits are available for all varieties and footprints of L-Series and L-Series with LED products and come in FIRE, ALERT, EVAC, AGENT, FEU, FOGO, FUEGO, FUEGO/FIRE, and Plain options making customization easy.

Universal Trim Rings for wall and ceiling mount devices allow for additional space within the backbox.

Surface Mount Back Boxes are the best solution in locations where you are mounting onto a hard surface. Red and White options provide best in class aesthetics for applications that require an exposed junction box. Surface Mount Back Boxes can be used with L-Series and L-Series with LED notification appliances.

The **Sync•Circuit Module** synchronizes the temporal coded horns and chimes and the flash timing of strobes.. Patented module technology also allows the silencing of horns or chimes on horn strobe and chime strobe models over a pair of wires. See the Sync•Circuit Datasheet for more information.

Agency Listings



S5512
S4011
S4048



S5512
S4011
S4048



FM approved: Lenses,
Sync modules and MP120KL.
3057383, 3057072, 3057493



7125-1653:0504
7135-1653:0503

MP120KL, MP120KLA Specifications

Physical/Operating Specifications	
Standard Operating Temperature	–40°F to 151°F (–40°C to 66°C)
Humidity Range	10 to 93% non-condensing (indoor products)
Nominal Voltage	Regulated 120 VAC
Operating Voltage Range	96–132 VAC
Current Draw From AC Line	150 mA max.

Bezel Installation

Installation to Wall-Mount Device

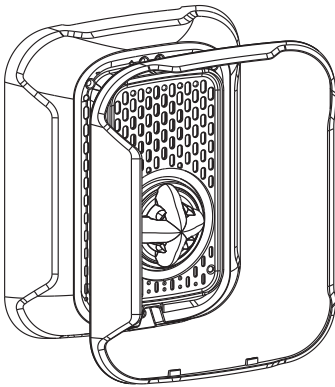

Installation to Ceiling-Mount Device

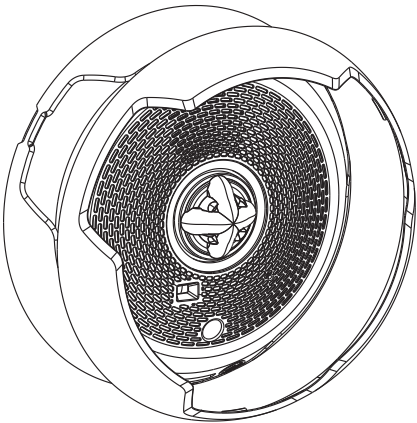

Colored Lens Installation

Installation to Wall-Mount Device

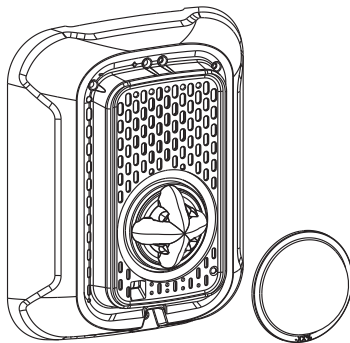

Installation to Ceiling-Mount Device

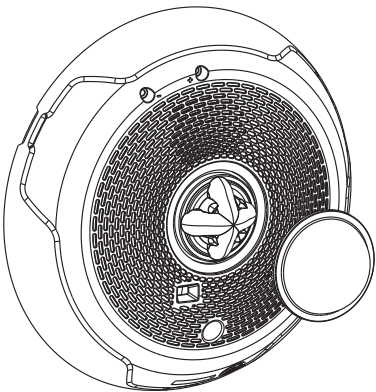

Ordering Information

Part No.	Description
Surface Mount Back Box	
SBBRL	Red, wall-mount, compatible with standard horns, strobes, horn strobes, chimes and chime strobes
SBBWL	White, wall-mount, compatible with standard horns, strobes, horn strobes, chimes and chime strobes
SBBSPRL	Red, wall-mount, compatible with speakers and speaker strobes
SBBSPWL	White, wall-mount, compatible with speakers and speaker strobes
SBBCRL	Red, ceiling-mount compatible with horns, strobe, horn strobes, chimes, chime strobes, speakers and speaker strobes
SBBCWL	White, ceiling-mount, compatible with horns, strobe, horn strobes, chimes, chime strobes, speakers and speaker strobes
SBBGRL	Red, wall-mount, compatible with compact horns, strobes, horn strobes
SBBGWL	White, wall-mount, compatible with compact horns, strobes, horn strobes
Bezels*	
BZR	Wall Red Bezel Kit
BZW	Wall White Bezel Kit
BZGR	Compact Wall Red Bezel Kit
BZGW	Compact Wall White Bezel Kit
BZRC	Horn Strobe Ceiling Red Bezel Kit
BZWC	Horn Strobe Ceiling White Bezel Kit
BZSPR	Speaker Strobe Wall Red Bezel Kit
BZSPW	Speaker Strobe Wall White Bezel Kit
BZSPRC	Speaker Strobe and Low-Frequency Ceiling Red Bezel Kit
BZSPWC	Speaker Strobe and Low-Frequency Ceiling White Bezel Kit

*Each bezel pack ships in a package of 5.

Add one of the following extensions for print/language options:

-F (FIRE), -AL (ALERT), -EV (EVAC), -AG (AGENT), -P (Plain),
-FR (FEU), -PG (FOGO), -SP (FUEGO), -SPE (FUEGO/FIRE).

Part No.	Description
L-Series with LED Colored Lenses	
LENS-A3	Lens LED Amber Wall/Ceiling
LENS-B3	Lens LED Blue Wall/Ceiling
LENS-G3	Lens LED Green Wall/Ceiling
LENS-R3	Lens LED Red Wall/Ceiling
Retrofit Plates (For use with horn strobe & speaker strobe devices)	
RFPW	9.5" x 7" (24.13 cm x 17.78 cm) white
RFP	9.5" x 7" (24.13 cm x 17.78 cm) red
Mounting Plate (For use with L-Series only)	
MP120KL	120 VAC Adapter Mounting Plate
MP120KLA	Same as MP120KL, with ULC listing
Sync Modules	
MDL3W	White, 12/24 volt Sync-Circuit module
MDL3WA	Same as MDL3W, with ULC listing
MDL3R	Red, 12/24 volt Sync-Circuit module
MDL3RA	Same as MDL3R, with ULC listing
Trim Rings	
TR-2	Universal wall trim ring, red, 6.3" x 8.2" (16 cm x 20.83 cm) (5-pack)
TRC-2	Universal ceiling trim ring, red, diameter 8.5" (21.59 cm) (5-pack)
TR-2W	Universal wall trim ring, white, 6.3" x 8.2" (16 cm x 20.83 cm) (5-pack)
TRC-2W	Universal ceiling trim ring, white, diameter 8.5" (21.59 cm) (5-pack)
TRCWLA-10	Ceiling trim ring, white, diameter 7.0" (17.78 cm) (10-pack)
TCRLA-10	Ceiling trim ring, red, diameter 7.0" (17.78 cm) (10-pack)

3825 Ohio Avenue • St. Charles, IL 60174 USA

Phone: 800-SENSOR2 • Fax: 630-377-6495

www.systemsensor.com

3333 Unity Drive, Mississauga, ON L5L 3S6 Canada

Phone: 800-SENSOR2 • Fax: 905-812-0771

www.systemsensor.ca

System Sensor® is a registered trademark
of Honeywell International, Inc.



©2023 System Sensor.

Product specifications subject to change without notice. Visit systemsensor.com
for current product information, including the latest version of this data sheet.
AVDS870-03 • 10/10/2023